

8017 PARK LANE

BETHESDA 20814 \$1,799,000

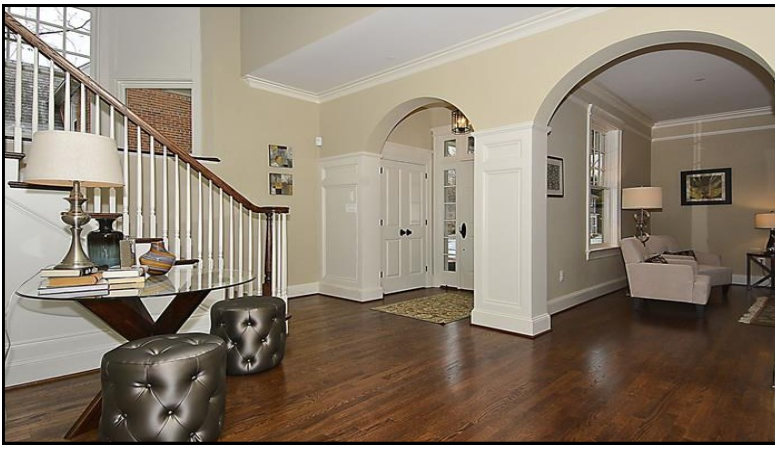

A custom new home with over 5,000 square feet of finished living space situated on a level lot within walking distance of downtown Bethesda is DOUBLY DESIRABLE! Carefully designed with architectural features that can be found in other homes nearby, this is a rare opportunity to own a new home in a prestigious and well-established community such as BATTERY PARK. Don't miss it!

Property Details

5 Bedrooms
 5.5 Bathrooms
 Year Built 2014—NEW!
 Lot Size: 7,250 sq ft
 Est. Taxes: TBD (\$18,000?)

Schools

Bethesda Chevy-Chase H.S.
 Westland M.S.
 Bethesda E.S.

Stuart & Maury,
 Inc. Realtors
 301-654-3200



ROBERT JENETS
 Cell: 301-257-3200
 President & Principal Broker
 Robert@robertjenets.com

All information deemed reliable, not guaranteed.

ROBERT JENETS
 RobertJenets.com
 Stuart & Maury, Inc. Realtors
 4833 Bethesda Avenue #200
 Bethesda, MD 20814

Office: 301-654-3200
 Cell: 301-257-3200
 Email: Robert@robertjenets.com



Main & 2nd Level Details

Entrance Foyer

Dramatic two-story foyer with sophisticated wood paneled walls is highlighted by the impressive turned staircase, featuring a double bay window bump-out—bright!

Living Room

This room is perfect for conversations around the wood-burning fireplace or choose a book from the built-in bookshelves and curl up in front of the bay window to read—comfortable!

Dining Room

Defined by its two wide arched openings and decorative columns, this generous room is as inviting as it is practical.

Butler's Pantry

This area provides more cabinet storage and has an extra sink set in an attractive granite countertop. There is a walk-in pantry for food storage.

Kitchen

Bright and cheerful, the Kitchen is dominated by abundant white flush close custom cabinetry by Cuisine de' Cabico and Carrara marble countertops. The cooktop, wall ovens and microwave are Wolf, the refrigerator is SubZero and the island has an oversized Blanco sink and two dishwashers that have the same fronts as the cabinets. Casual dining is easy at the breakfast bar or in the adjacent bay windowed breakfast area.

Family Room

Open to the Kitchen but defined by two decorative columns, the Family Room has a coffered ceiling, a gas fireplace flanked by two charming window seats and French doors to the Patio.

Office

This main level room allows for privacy from everyday activities without being isolated on another floor.

Powder Room

Nicely tucked away off the center hall.

Master Bedroom

The Master Suite is accessed through a private hall vestibule that leads to both the Master Bedroom and the generous walk-in closet. Those two rooms connect with the luscious Master Bathroom.

Master Bath

Keeping with the theme of white cabinetry and Carrara marble, this bright space offers a deep and luxurious soaking tub, two separate sink vanities and a large shower with multiple shower heads. Of course, there is a private water closet and the tilework in this bathroom is outstanding!

Bedrooms 2, 3 and 4 on the second level

All three of these rooms are well-sized with ample closet space and en-suite baths. **Note: the hardwood flooring runs throughout the entire second level.**

Laundry Room

A large, well-designed space with a laundry sink for soaking and front loading washer and dryer.

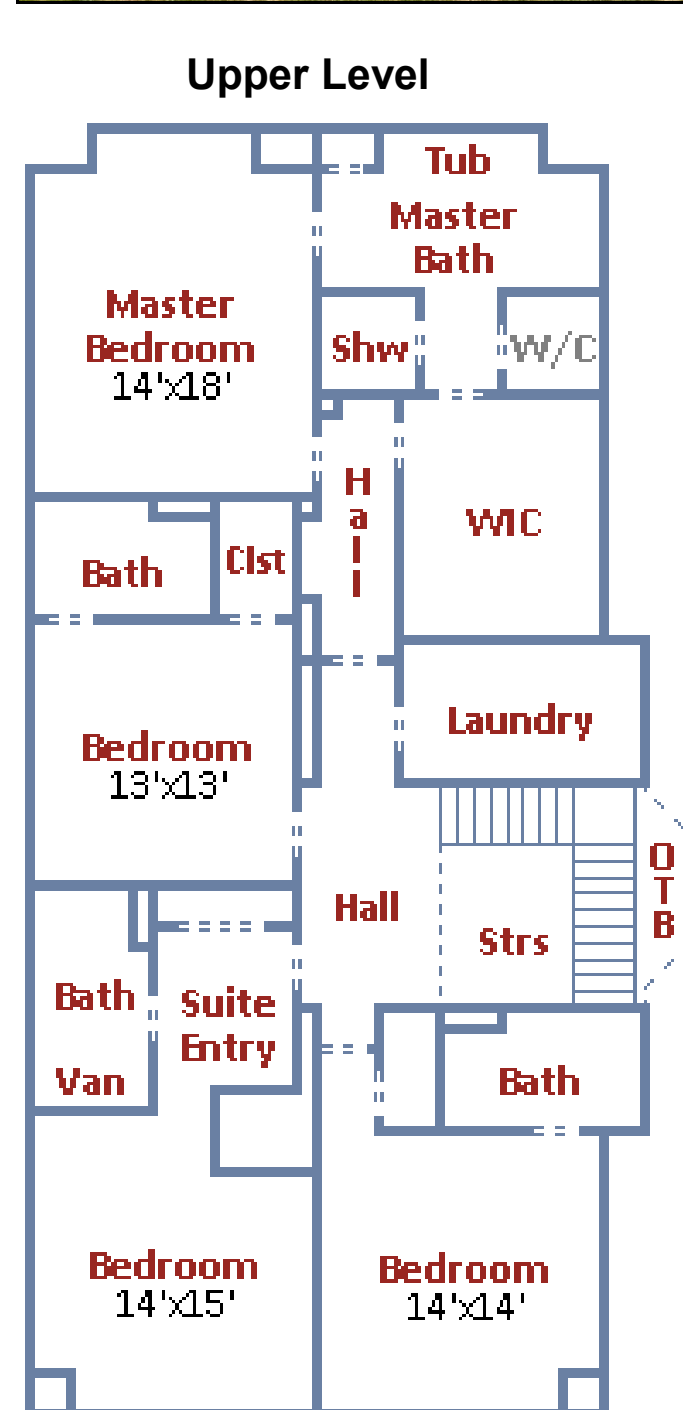
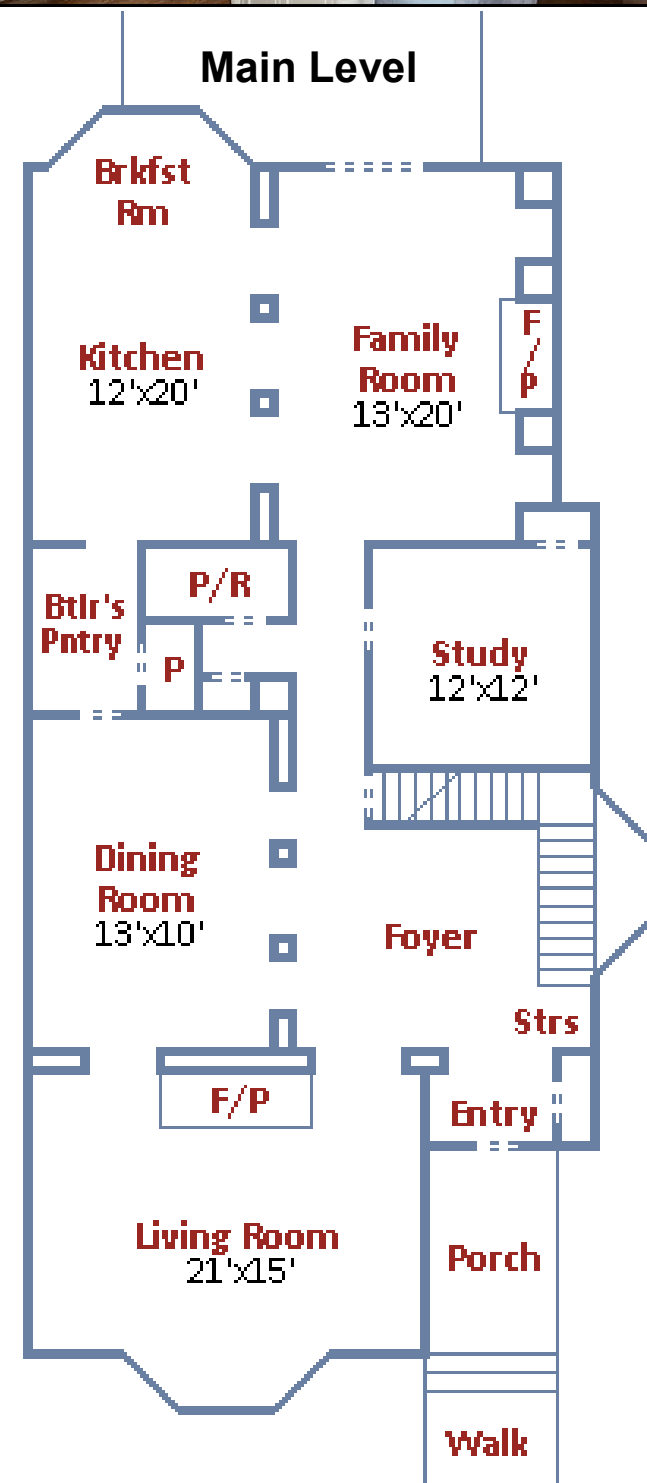

Additional Information

Built by Rasevic Construction Co.
5200 River Road, Building Six
Bethesda, MD 20816

Approximately 5,250 sq ft of finished space

Permeable paver driveway

10-foot ceilings on Main Level, 9-foot ceilings on Second Level

Prewiring for data, cable and telephone in Library, Kitchen, Family Room and all Bedrooms

One-car detached garage with automatic door opener

High Efficiency HVAC systems, programmable thermostats

Energy Star qualified Appliances

